

THE POSSESS THE LAND CAMPAIGN IS IN FULL SWING

The communication phase of our capital campaign began two weeks ago with the mailing of a brochure to church families. During the next four weeks, families will be fully informed about our capital campaign, and more importantly, the relocation and expansion of our Church the campaign will help us accomplish. Our families are encouraged to seek God's leadership as they determine their financial commitments to that campaign effort. **"Equal sacrifice, not equal gifts"** will be the major emphasis.

A Vision Banquet, Sunday evening, April 27, will conclude the communication phase of the

campaign. Immediately afterward, families will receive commitment cards in the mail inviting them to make a three-year, weekly or monthly capital commitment. The total of all commitments will be announced at a Celebration Service, Sunday, May 18.

Our goal is to substantially pay for our building projects in three years instead of assuming a long-term debt. If we are successful, thousands of dollars in interest payments will be saved and our regular budget will be free of the pressure that a long-term mortgage frequently imposes. Capital campaign commitments are to be over and above any present giving for the budget and missions.



The Campaign Director, John Stockton, along with our Pastor, will be reviewing the **Possess the Land** calendar. They are leading the effort to raise funds in our capital campaign over the next three years to pay for the major upgrades to our new Church building that are planned.

A Word from Our Pastor

The family of First Baptist Church has a dream—a dream of truly being God's people on mission. We are committed to reach people here at home, and we are committed to give generously to mission causes around the world. Recently, we reaffirmed our dream, determining to relocate and expand a new Church home—a place for worshiping and serving God. Those new facilities will enable us to more effectively minister to our present congregation and to reach out to others in our community. In turn, and meet other needs both now and in the future.

Our goal now is to pay for that expansion through sacrificial giving. Our strategy, a capital stewardship campaign called Possess the Land, is a means of challenging church families to give sacrificially each week or each month to the building fund over the next three years. This plan will enable us to provide for our space and growth needs now, save thousands interest costs, protect our regular ministry budget

Already I have determined my commitment. Certainly, I would not ask you to give sacrificially unless I was already committed to do so myself. I believe this effort is that important. I ask one thing of you. Please pray about your family's commitment. Ask God to help you find the right figure to commit to give over the next three years. Then make your commitment, trusting God to help you give what you have committed. our church will have a greater potential for supporting other mission and ministry causes.

Case Statement for Possess the Land

Some folks are asking, **Why do we need a capital campaign?** Can't we just make payments? The case statement below was written to answer that important question.

First Baptist Church Festus & Crystal City has been a devoted church to the Lord for over 135 years and has established a lasting legacy of faith in the community. God has blessed this church in remarkable ways and we are thankful for the example of faithfulness and sacrifice of previous generations. Now it's our turn to follow their lead by relocating and building for the future to advance God's kingdom in our community.

25 years ago, the church followed God's leading to relocate the church to where the city was projected to grow by 2020. In 2008 40 acres was secured on Platin Road as a first step to make this vision a reality. In 2019 the Family Life Center was constructed as the cornerstone. We are grateful for the sacrifice that has already been invested by those who went before us. They dreamed for the moment before us.

Now, the church has stepped out in faith to make this vision a reality by conducting a capital campaign with the theme, Possess the Land. As suggested by the theme, it is an opportunity to fulfill the goal of relocating the church to keep up with the growth and direction of our city; and changing ministry needs. This is a God-sized task that can only be accomplished with faithfulness, sacrifice, and generosity. Our motto is, "Not equal gifts, but equal sacrifice." This way, everyone can invest into what God is doing!

The goal is for the church to centralize in one location for worship, discipleship, fellowship, and ministry. Our community is growing and, like 100 years ago when the church moved to our present location from Moore Street, it is now time to make the vision of relocating to Platin Road a reality. The major focus of this campaign will address the following objectives:

- Adding an education building to our existing Family Life Center that will accommodate all our ministries and age groups; and act as our home base
- Prepared to embrace the growth in our community that is here and still coming.
- Create a welcoming environment for families, including attractive and secure Preschool and Children facilities
- Efficiently and responsibly utilize our resources to best align with the campus master plan and goals of the church.

Someone has said, "Great moments are born from great opportunities." This is our moment. Please pray for the campaign and how God wants to use you and your family to meet the commitment and success of the Possess the Land capital campaign.

VISION BANQUET

A very special fellowship experience is planned—our Vision Banquet, April 27. This special event will conclude the heart of our capital campaign—the Communication phase. Several special and important features will be shared that evening. Please circle this date on your calendar. Make sure that every member of your family is aware of the date and reserves it to experience this important worship experience.

Special features of the Vision Banquet include inspiring testimonies and music, a challenging message from our Pastor, and an announcement about the start of the commitment phase of our campaign. Lori Andrews, our Commitment Director, will introduce the Commitment Response phase of the campaign which begins April 28. Please be in prayer for the commitment team, and pray about what your family will decide about your commitment.

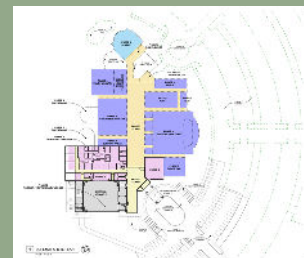
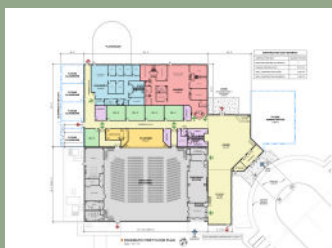

I Have a Question!

What is our Possess the Land capital campaign?

It is a three-month effort to challenge our congregation to give sacrificially to provide funds to help pay for our relocation and expansion within the next three years. Campaign gifts are to be in addition to any present support of our Church's budget and missions. The communication phase of the campaign is now underway, concluding with a special **Vision Banquet, April 27**. Families are encouraged to seek God's leadership as they determine a three-year, weekly or monthly, commitment for their giving. Though people involved in campaign leadership will make their commitment decisions before Vision Sunday, most families will be invited to make their commitments during the two weeks following that event

Why don't we just borrow and make payments on those projects?

Some interim borrowing may be needed. This campaign will help us make those payments. However, our ideal intention is to pay for those projects from campaign gifts and avoid taking out a loan. A dollar given is worth 2 to 3 borrowed dollars. That is money we can re-invest in our ministry which is so important to our future growth!

Important Campaign

Dates:

April 27
Vision Banquet

April 28 - May 17
Commitment Response Phase

May 18
Celebration Service

June 1
First Fruits Sunday (Three-year Giving begins)

FAMILY HEARING TESTIMONIES

During these weeks in Sunday worship services, a few families will be sharing their testimonies of commitment in our **Possess the Land** capital campaign. They will relate how they reached their decisions in response to God's leadership. The names of those giving testimonies will be listed in the Sunday worship bulletins. The first testimonies have already been given.

The testimonies express the convictions, concerns, and enthusiasm of our people for our new building and this campaign to pay for it. Their testimonies will bless and enlighten each of us. If you feel led to share your family's commitment, please contact John Stockton, Campaign Director, who is scheduling all testimonies.

Equal sacrifice, not equal gifts - WHAT DOES IT MEAN?

We are using the theme, Equal sacrifice, not equal gifts, in our **Possess the Land** capital campaign. It means that families are encouraged to give in the same spiritual attitude of sacrifice rather than giving the same amount.

What is sacrifice? In Old Testament times, sacrifice meant giving up something of value for something of greater value. The Hebrews were taught to give their very best when making an offering to God. The

value of the gift was not measured by the amount, but by its sacrifice. When a friend offered to buy a piece of land for David to give to the Lord, David said, "I will not give to the Lord my God offerings which cost me nothing." (2 Sam. 24:24, NIV)

Throughout our lives, we regularly sacrifice for things we think are important, such as an education, a home, a business, or our future needs. Why not give sacrificially

when we have an opportunity to strengthen the work of our church and extend the kingdom of God?

We encourage each family to pray about a truly sacrificial commitment. Near the conclusion of our campaign, each family will have an opportunity to indicate their commitment in Possess the Land on a commitment card. If indeed each commitment reflects sacrifice, then the church will celebrate a great victory on Celebration Sunday.

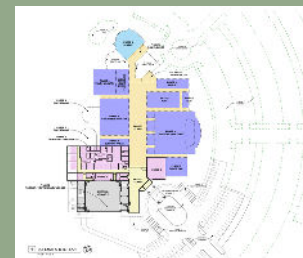

Do You have a Question?

There are no secrets about any aspect of **Possess the Land**. If you have a question, don't hesitate to ask any member of the steering team. They will answer your question or direct you to someone with an answer. A campaign manual is also available for all to view in the Church office.



POSSESS THE LAND

FIRST BAPTIST CHURCH
OF FESTUS, CRYSTAL CITY
107 N TRUMAN BLVD
CRYSTAL CITY, MO 63019